

INSTALLATION INSTRUCTION

- 1 Sling
- 2 Suspension Wire
- 3 Rollerball barrel
- 4 Suspension Channel
- 5 Luminaire
- 6 End Plate (shown without magnetic cover plate)
- 7 Mounting surface
- 8 Beam or Support
- 9 Screw/Fixture

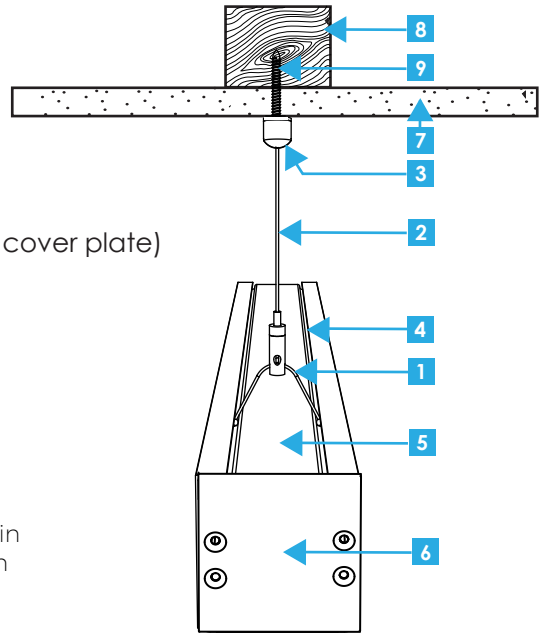

Installer must ensure that the slot orientation in ceiling barrel allows suspension wire to remain perpendicular at all times in all orientations

1

Determine mounting location

3

Can be mounted on flat ceiling, raked ceiling & wall

4

Barrel
Screw (Not supplied)
Ceiling
Screw Rollerball to mounting service

5

Insert wire into barrel

6

Feed main wire through clutch
grub
Then slide sling into clutch & tighten with grub screw

7 Remove diffuser

8

Then, remove geartray by sliding clip as shown here.
Please take care not to touch LED chips during process

9

Remove endplate (only as required)

10

Slide sling and barrel into channels on top of profile. Repeat this twice for each length

Instructions continued next page

Continued

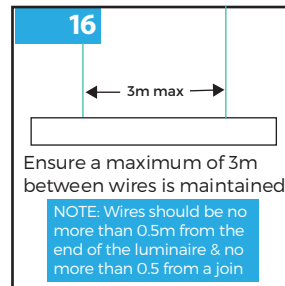
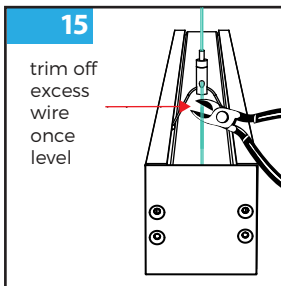
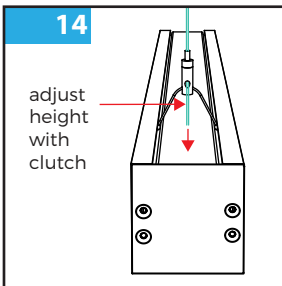
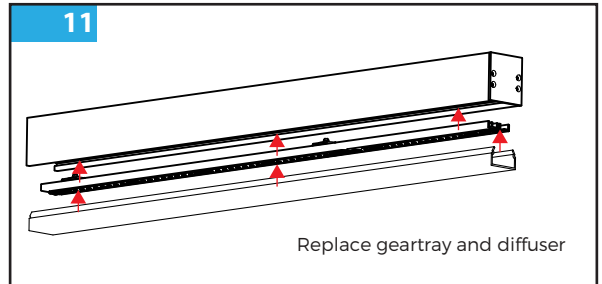
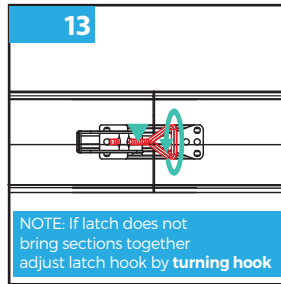
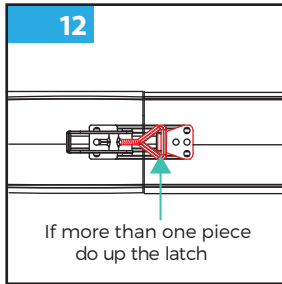

INSTALLATION INSTRUCTION

- 1 Sling
- 2 Suspension Wire
- 3 Rollerball barrel
- 4 Suspension Channel
- 5 Luminaire
- 6 End Plate
- 7 Mounting surface
- 8 Beam or Support
- 9 Screw/Fixture

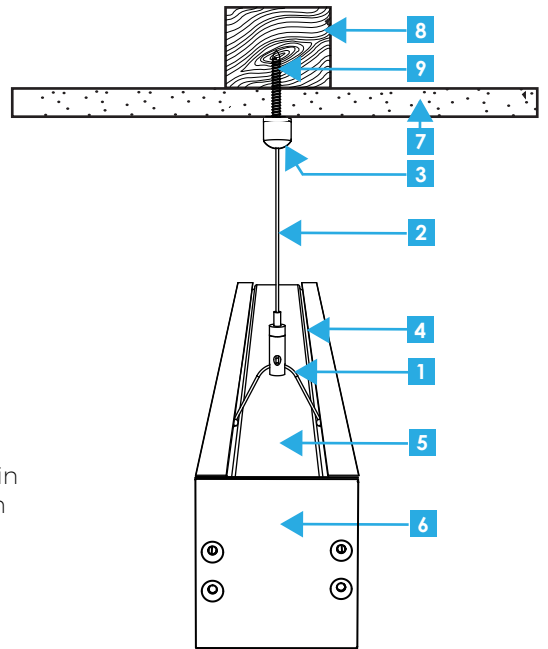

Installer must ensure that the slot orientation in ceiling barrel allows suspension wire to remain perpendicular at all times in all orientations

FOR PENDANT FITTINGS
 Note: Slings and barrels will be installed on profile during factory assembly

Determine mounting location

2

Can be mounted on flat ceiling, raked ceiling & wall

3

Ceiling
 Barrel
 Screw (Not supplied)
 Screw Rollerball to mounting service

4

Insert wire into barrel

5

Feed main wire through clutch
 grub screw

6

Illustration shows slings and barrels pre-assembled in profile channels at manufacture for pendant fittings

9

adjust height with clutch

10

trim off excess wire once level

11

3m max
 Ensure a maximum of 3 metres between wires is maintained
 NOTE: Wires should be no more than 0.5metres from the end of the luminaire and no more than 0.5 metres from a join

If more information is required please contact you local representative by going to xerolighting.com/contact or email us at headoffice@xerolighting.com