

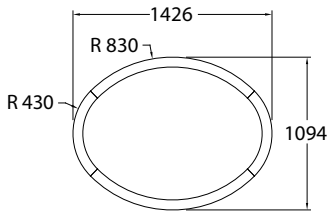

XTA | 2.0 Ellipse Recessed 1426
Run Length 3.958m

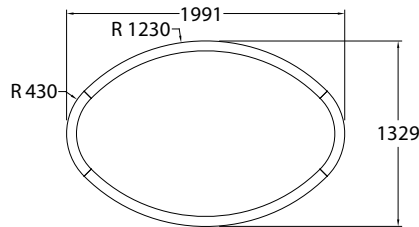

XTA | 2.0 Ellipse Recessed 1991
Run Length 5.215m



XTA | 2.0 Ellipse Recessed 2226
Run Length 6.472m

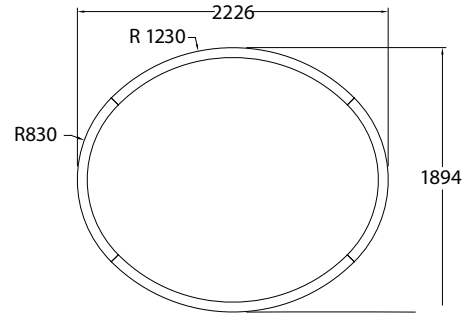

DATA TABLE

| | | | |
|-------------------------|-----------|--|--------------|
| Optic Module LED Engine | Proformax | CRI | 90+ |
| | | Lumen Maintenance | 82,000 Hours |
| Warranty | | 7 years | |
| Dimensions | | Profile size 60mm (with flange 86mm wide) x 100mm Ellipse sizes - 1426 x 1094mm / 1991 x 1329mm / 2226 x 1894 | |
| Weight | | XTA 2.0 Ellipse Recessed 1426 (9.7kg (21.4lbs)) / XTA 2.0 Recessed Slot 1991 (12.8kg (28.2lbs)) / XTA 2.0 Ellipse Recessed 2226 (15.5kg (34.2lbs)) | |
| IP Rating | | IP20 (dry indoor application only) | |
| Compatible ceiling type | | Suitable for gyprock (drywall) ceilings, metal pan, concrete, timber and T-bar grid ceilings | |
| Mounting | | Wire suspensions, rod suspensions, surface mounting, ceiling mounting | |

To create fully customisable variations of these profiles go to -

<https://xerolighting.com/products/xta-2-0-loop-slot/>

XTA | 2.0 Ellipse Recessed
specification sheet

